

Team Four

JC-001-012423

Report Date May 11, 1999	Thornton Police Report of Investigation	Thornton Case Number 99-4919
Type of Report Crime Scene	Report submitted by Robert Lloyd	Jefferson County Sheriff Case Number 99-7625

NATURE OF CASE Homicide

CRIME SCENE REPORT FOR TEAM FOUR

REQUESTING

AGENCY: Jefferson County Sheriff's Office

INVESTIGATING

OFFICER: Lab Supervisor Chris Andrist

**DATE OF
REQUEST:**

April 20, 1999

**DATE OF
OFFENSE:**

April 20, 1999

**AGENCY CASE
NUMBER:**

99-7625

**LOCATION OF
SCENE:**

Columbine High School, 6201 South Pierce Street, Jefferson County, Colorado

VICTIM:

David Sanders DOB: (102251)

SUSPECTS:

Eric Harris DOB: (030981)
Dylan Klebold DOB: (091181)

WEATHER:

Variable

**EVIDENCE
SEIZED BY:**

Jefferson County Sheriff's Deputy Steve Stalter

JC-001-012424

Type of Report Crime Scene	Technician R. Lloyd	Date 05/16/99	J.C.S.O. File 99-7625	Page - 2 -
-------------------------------	------------------------	------------------	--------------------------	---------------

**EVIDENCE IN
CUSTODY OF:**

Same as above

REMARKS:

This is report by Team Four, assigned to the science area that contained the body of David Sanders, at Columbine High School. The team was also assigned the south and central portion of the school. In addition to Lloyd, the reporting team leader, other members and their duties were:

- Tony Gallardo, Arapahoe County Sheriff's Office
Sketching
- Bruce Davis, Greenwood Village Police Department
Video, measurements and trajectory
- Stephen Adams, Arvada Police Department
Photography, bullet trajectory
- Steve Stalter, Jefferson County Sheriff's Office
Photo and evidence log, collection of evidence.

On Tuesday, April 20, 1999, Team Four members responded at various times to a staging area set up on Pierce Street, north of Columbine High School, to assist JCSO in the investigation of multiple deaths, shots fired and explosions. No teams entered on April 20 due to safety concerns with the presence of unexploded devices.

On Wednesday morning, April 21, 1999, a planning meeting was held. Team leader Robert Lloyd, along with Chris Andrist, JCSO, Tom Griffin, C.B.I., and Sergeant Randy West were appointed as co-crime scene coordinators. The purpose of the group was to establish procedures for documenting the scene and setting up crime scene teams.

After an assessment of the scenes by members of the Jefferson County Sheriff's Department, and Jefferson County Coroner's office, a preliminary walk through was conducted to establish assignments.

Agent Griffin documented the scenes with 35mm photographs and Robert Lloyd videotaped the bodies. Another back up 35mm and video team, consisting of Criminalist Tom Adair, Arapahoe County Sheriff's Department and Chris Loptien, JCSO, also videotaped and

Type of Report Crime Scene	Technician R. Lloyd	Date 05/16/99	J.C.S.O. File 99-7625	Page - 3 -
-------------------------------	------------------------	------------------	--------------------------	---------------

photographed the bodies. The documentation commenced at 10 a.m. and was completed at 12 noon.

On April 21, 1999, at approximately 12:30 p.m., Chris Andrist assigned crime scene personnel to various teams. This meeting was conducted to ensure a standardized approach to all of the scenes. Each team member was then escorted through the various scenes in the school for an assessment of evidence.

Photographs were taken to record the areas investigated by Team Four. Each photograph was documented in a photo log, which is a part of this report.

Team Four was issued evidence numbers 1500 through 1699. An evidence log was maintained to record the numbers used by Team Four. Measurements were taken on each item of evidence collected for inclusion in diagrams and will not be repeated here.

Columbine High School is located on the west side of Pierce Street at the intersection of Fair Drive. The main entry to the school faces east with parking lots on the south side of the school and on the northeast side. Various athletic fields are located on the west and northwest areas of the school grounds and Clement Park borders the north side. The school is a two-story structure with the main entrance being on the upper level. There is exterior access to the lower level on the south and west sides. The main or central hallway for the school runs east and west with the front doors being on the east side and the office area just to the north of the main entrance. The north side of the central hallway on the main level consists of the administrative offices, the gymnasium, the band room and specialty classrooms such as the wood shop, ceramic studio and photography. Numerous other smaller classrooms are also located north of the main hallway. South of the main hallway is the primary classroom area for Social Studies, Language Arts, Math and Science. It also contains the auditorium. The library is located in the west end of the main level with the cafeteria being on the lower level directly underneath the library.

Type of Report Crime Scene	Technician R. Lloyd	Date 05/16/99	J.C.S.O. File 99-7625	Page - 4 -
-------------------------------	------------------------	------------------	--------------------------	---------------

There is a south entrance to the school on the lower level at the west end. This enters the southeast corner of the cafeteria. There is a stairway that goes from this location to the main level at an intersection of hallways at the southeast corner of the library area (see diagrams). The Science area is in the southwest side of the school on the main level. There are ten classrooms in this area labeled SCI-1 through SCI-10. There are two Science office rooms and a chemical storage area (see diagrams). There is a storeroom on the west side of SCI-1.

This science storeroom has a doorway on the east side into SCI-1 as well as a doorway on the north side onto to the hallway at the top of the stairs coming up from the cafeteria on the lower level. This hallway at the top of the stairs from the lower level runs east and west and is another main hallway south of the central hallway. This hallway intersects with a hallway that runs north and south in front of the library area. These two hallways intersect at the southwest corner of the school above the southwest entryway on the lower level. The west wall of this science storeroom is also the east wall of the southwest entryway to the school. One victim of the shooting was found in this science storeroom on the west side of SCI-1.

Science Area Diagram (For reference only-not to scale)

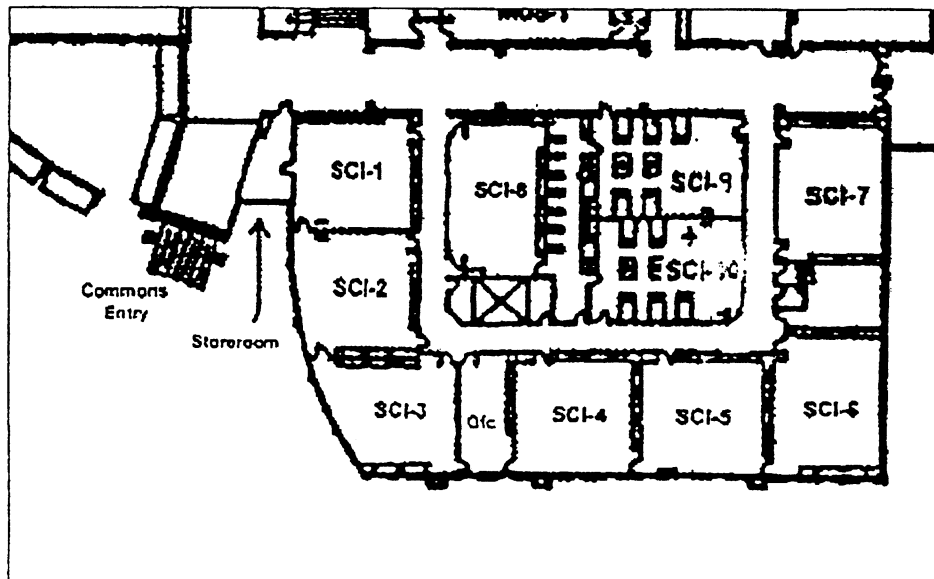

Type of Report Crime Scene	Technician R. Lloyd	Date 05/16/99	J.C.S.O. File 99-7625	Page - 5 -
-------------------------------	------------------------	------------------	--------------------------	---------------

ACTION TAKEN: On April 21, 1999, Team Four entered the building at approximately 1:35 p.m. The processing of the scene continued until Tuesday, April 27. The approximate scene activity times were as follows:

Wednesday, April 21st, 1:35 p.m. to 6:00 p.m.

Thursday, April 22nd, 8 a.m. to 6 p.m.

Friday, April 23rd, 8 a.m. to 6:30 p.m.

Monday, April 26th, 8 a.m. to 7 p.m.

Tuesday, April 27th, 8 a.m. to 2:30 p.m.

Science Storage Room/ Body #13

In the science storage room was the body of a white male, which had been previously designated as body # 13, later identified as teacher DAVID SANDERS. The body was on the floor positioned on his back. His head was pointed north towards the hallway door in the room. His feet were pointed south and his arms were down along his sides. Mr. Sanders was bare chested. His blue and white dress shirt and T-shirt were cut and pulled down to the waist. He had gray slacks and brown shoes. Under the body was a flannel shirt and next to the head was a gray sweatshirt. These items appeared out of place with the clothing Sanders was wearing. It was noted that there was an absence of blood under the body. There did not appear to be any evidence in the room to indicate that this was where this victim had actually been shot.

Initially there were two wounds visible: one was in the upper mouth and he appeared to be missing two teeth; the other was an apparent bullet wound on the front of the right shoulder. Once the initial documentation was completed, the Coroner's Office was requested to respond to conduct their examination. Triena Harper of the Jefferson County Coroner's Office and a member of the Denver Coroner's Office responded and conducted an investigation on the victim (see also: Coroner's Report). The examination disclosed two additional bullet wounds in the victim's back, one on the upper right shoulder and one at the base of the lower left side of the neck. The bullet wound on the back of the right shoulder appeared to be related to the bullet wound on the front right shoulder. The bullet wound at the base of

Type of Report Crime Scene	Technician R. Lloyd	Date 05/16/99	J.C.S.O. File 99-7625	Page - 6 -
-------------------------------	------------------------	------------------	--------------------------	---------------

the neck appeared related to the wound in the victim's mouth.

The victim had a wallet, which tentatively identified him as William David Sanders, dob: 10/22/51, with an address of [REDACTED], and described him as a white male, 6' tall, 190 lbs., brown hair, blue eyes and wearing corrective lenses. The driver's license was a Colorado driver's license #942973429 and showing a social security number of 315-54-0935.

The victim was placed in a body bag, which was sealed and carried to the Coroner's vehicle at the front entryway to the school. After the body was removed from the storeroom, additional photographs were taken to document the room without the body present.

Located in the hallway, just outside the storage room door, were two large pools of suspected blood on the carpet. In both pools of blood (items #1513-1514) were suspected bone fragments. Between the pools of blood and the north storage room wall, the team recovered a single tooth on the floor (#1517).

East of the large pools of blood the team observed additional bloodstains in the carpeting. The first one appeared to be a right hand, believed to be Sanders, due to the close proximity of the tooth and tooth fragments. This pattern had all fingers and thumb patterns in the carpet. A few inches further east the team observed a bloody outline consistent with knuckles of a hand, with voids where the back of the fingers would have pressed on the carpet. Further east along the blood trail was a second right hand impression, with fingers and thumb.

The staggered blood trail continued east then turned south toward Science Room 1 (SCI-1). On the door of SCI-1 there was blood on the door handle and several blood drops on the floor below the handle, as if someone had been standing there. The trail did not enter the room.

The blood trail continued south past the two doors for SCI-2. The blood trail did not enter this room. It continued to SCI-3 where it did enter the room. There was a large pool of blood

Type of Report Crime Scene	Technician R. Lloyd	Date 05/16/99	J.C.S.O. File 99-7625	Page - 7 -
-------------------------------	------------------------	------------------	--------------------------	---------------

in front of the black chalkboard, which is on the east wall. Several feet away were additional bloodstains along with several T-shirts, a fire blanket, and additional clothing on the floor covered with blood. There was a tooth fragment (#1537) on the floor. On the floor was a portion of a blue and white dress shirt (#1538), consistent with the shirt found on DAVID SANDERS in the science storage room. A pair of blood stained glasses (#1539) was located on a desk along the north wall.

On the floor in the southwest corner of SCI-3 was a hand-lettered sign (#1540), which read, "1 BLEEDING TO DEATH."

In SCI-2, eight tables were set up in a barricade like position across the back of the room. The bloodstains on the floor indicate Sanders was pulled from SCI-3, through SCI-2 (behind the table barricades), through SCI-1 and into the science storage room.

In summary, the investigation revealed that SANDERS was shot twice while in the hallway outside the science storeroom. He probably crawled east until reaching the next hallway junction where he turned south. He opened the door to SCI-1 but did not enter. He then continued south to the end of the hall and entered SCI-3. He was subsequently taken from there across the backs of SCI-2 and SCI-1 to the science storeroom.

Processing of the science storage room and victim was completed at about 6:00 p.m. This completed the work on April 21, 1999.

On April 4, 1999, Team Four returned to the scene of Columbine High School and signed in at approximately 0800 hours. At this time the team began to measure the evidence that had been located and numbered on the previous day. Again photographs were taken to document each item of evidence with the number plaque in view. Where appropriate, the items were photographed with and without a scale. This included evidence item #1500 through item #1553. See the evidence recovery log for the details relating to the individual items.

JC-001-012430

Type of Report Crime Scene	Technician R. Lloyd	Date 05/16/99	J.C.S.O. File 99-7625	Page - 8 -
-------------------------------	------------------------	------------------	--------------------------	---------------

A decision was made to mark all holes and impact points on walls and windows with numbers prefixed by the letter "BH" since it was sometimes difficult to determine whether the hole or impact was made by a bullet, shotgun round or bomb fragment. All holes and impact marks were measured to document their position (see diagrams). All penetrating impacts were searched to try and locate the projectile causing the hole. When found, they were photographed and measured for location. Where appropriate, probes were used to determine trajectories and relate specific evidence to the holes. Photographs were taken of these holes both with and without the probes in place.

Hallway South of Library

Examined and photographed were numerous bullet holes and defects in the south wall and windows at the west end of the southern east/west hallway. The windows overlook the entryway for the south entrance and to the lower level commons area. A total of 16 holes or impact points were noted. BH-1 was a hole through the lower portion of the wall close to the west edge of the wall with the Science storeroom. This projectile went through the south wall of the hallway and into the west wall of the storeroom and was recovered inside the wall just south of the sink and cabinet located in that room. The projectile recovered appeared to be a bullet fragment and was recovered as item #1548.

The hole designated as BH-2 located in the lower left hand area of that section of wall (as you look towards the south) was approximately one and one-half inch in diameter and may have been made by a piece of bomb fragment. This hole penetrated the wall and is associated with a hole gouged in the west wall of the Science storeroom. The projectile did not penetrate this wall and would have fallen to the floor in the entryway of the commons area. The size of the hole would be consistent with the end cap of one of the bomb devices.

BH-3 was a small hole in the molding at the base of the wall in line with a tear in the carpet south of that location which was designated as evidence item #1503. The projectile causing this hole penetrated the south wall of the hall and

Type of Report Crime Scene	Technician R. Lloyd	Date 05/16/99	J.C.S.O. File 99-7625	Page - 9 -
-------------------------------	------------------------	------------------	--------------------------	---------------

also penetrated into the west wall of the Science storeroom. The projectile recovered in the wall appeared to be a bullet fragment and was designated as evidence item #1553.

The hole BH-4 was caused by a projectile going through the south wall below the windows and impacting the window frame at the south end of the east wall of the commons entry area (subsequently recovered as evidence item #1618).

The hole BH-5 was on the lower edge of the window on the south wall. The projectile did not penetrate the metal window frame and is believed to be a bullet fragment which was found directly underneath that spot, that being item #1543.

The hole BH-6 was caused by a projectile that penetrated the vertical window frame for the center portion of the window of the south wall and the projectile was lodged inside the frame. This was a bullet subsequently recovered as evidence item #1616.

The holes BH-7, BH-8 and BH-9 are holes through the window glass of the window on the south wall. These may relate to impacts on the south wall of the entry to the commons area (BH-48, 49, and 50).

The impact point designated as BH-10 was a mark on the wall in the shape of the profile of a flathead screw. A screw of the same size and shape was recovered from the carpet south of that location and was evidence item #1502.

The hole BH-11 was in the wall on the west side of the windows. The projectile causing this hole penetrated the wall and pointed directly to a broken window above the south entry to the commons area. This projectile also penetrated that window and no evidence item was recovered that could positively be associated with that hole.

The hole BH-12 was the furthest west impact on the south side of that hallway wall. This is a low impact into the drywall behind which was a concrete pillar. Numerous lead fragments were recovered from this hole and designated as item #1550.

Type of Report Crime Scene	Technician R. Lloyd	Date 05/16/99	J.C.S.O. File 99-7625	Page - 10 -
-------------------------------	------------------------	------------------	--------------------------	----------------

The hole BH-13 was located in the wall over the windows on the south wall with the projectile penetrating completely through the wall. No associated evidence item was recovered.

BH-14 was actually a metal fragment stuck in the wall above the windows. This was recovered as evidence item #1551.

The hole BH-15 was also above the windows but did not penetrate to the other side. The wall was opened up and a metal fragment was found lodged in the insulation between the inner and outer walls and collected as evidence item #1548.

The hole BH-16 was in the wall above the windows and penetrated through to the area above the entryway for the commons area. No item was recovered for this hole.

Science Room #8

Overall photographs were taken in SCI-8 where it was apparent that shots had been fired through the window of the northwest door, into the classroom in a southeasterly direction. A table, inside the room had been tipped up in front of the door. Two fired shotgun shells and three fired 9 mm casings were found outside the doorway to this room (see evidence item #1525 through #1529).

New Information Received

At approximately 1600 hours on April 22, 1999 the team was advised by Scott Mundine, an agent for the Colorado Bureau of Investigation, that interviews had indicated a student had a video camera in the music room that contained images of one of the suspects from the previous Monday. This room was found to be Music-1 and with the description given to Scott Mundine the associated evidence was found in that room. This was a backpack, a Sony video camera, a blue hat and a white t-shirt. These items were photographed and their location measured. They were not collected pending an examination by bomb squad personnel.

At approximately 1630 hours, the team was contacted by Chris Andrist who advised that other interviews indicated a student in one of the Math rooms also had videotape of at least one of the suspects. This was found to be Math room

Type of Report Crime Scene	Technician R. Lloyd	Date 05/16/99	J.C.S.O. File 99-7625	Page - 11 -
-------------------------------	------------------------	------------------	--------------------------	----------------

#10 and was associated with a student Eric Veik. A backpack, plastic bag of videotapes and a video camera bag were found at this student's desk in Math #10. The photographic documentation of these items was deferred to the next day.

The photographs taken on April 22, 1999 included roll #7 through roll #12. The team cleared the scene at Columbine High School at approximately 1700 hours.

Math Room #10

On Friday, April 23, 1999, the team entered Columbine High School at approximately 0800 hours. Photographs were taken to document Math #10 and specifically the desk of Eric Veik. His desk was in the third row from the east and was the second desk from the south. A test paper on the top of the desk showed the name Eric Veik, also on the top of the desk was a pencil and a calculator. On the north side of the desk was a black backpack. On the south side of the desk was a black video camera case and a plastic Target bag containing six Sony VHS tapes. (See evidence items #1559 through #1562). It should be noted here that neither these items nor the backpack and other items in the music room had yet been searched by the bomb squad.

Science Room #8 (continued)

Team Four returned to SCI-8 to continue the photographing and documentation of the evidence in this room. (See evidence item #1563 through #1586.) This evidence consisted primarily of fired bullets, lead fragments and shotgun shell wads. As previously stated it appears the shots fired into the room came from the northwest door going southeast across the room towards the southeast door of the classroom. As done previously in the hallway, bullet or projectile impacts and holes were designated with a number preceded by the prefix "BH."

BH-16 was a hole in a plastic electrical conduit along the east wall of Science room #8. A bullet fragment was recovered from inside this conduit as evidence item #1582. (It was later noted that BH-16 was used previously, so there are now two references to this number).

Type of Report Crime Scene	Technician R. Lloyd	Date 05/16/99	J.C.S.O. File 99-7625	Page - 12 -
-------------------------------	------------------------	------------------	--------------------------	----------------

BH-17 was an impact in the east wall, which penetrated the wall and exited into the chemical storage room on the east side of SCI-8. The projectile impacted two metal cabinets inside this room and was recovered on a shelf as evidence #1585.

BH-18 was an impact point on the east wall of SCI-8 and recovered was a small fragment imbedded in the wall as evidence item #1581.

BH-19 was an impact point on the east wall. No fragments were recovered.

BH-20 was an impact point on the east wall through a Wolf poster. The projectile went partially through the wall and was imbedded in the insulation between the walls. This was recovered as item #1584.

BH-21 was a hole in a lower cabinet door on the east side of the room, the cabinet being directly under the sink. The projectile was recovered from within the door as evidence item #1577.

BH- 22 was an impact point on the top drawer of a cabinet on the east wall underneath the sink. This was an impact point only. No evidence was recovered from this spot.

BH-23 was impact point on the east wall at the top of the Wolf poster. This is an impact point only.

BH-24 was a hole in a box sitting on the east counter just south of the sink area. The projectile went through this box and impacted a Safeway sack. The hole in the Safeway sack was marked as BH-25. The projectile continued though the Safeway sack and impacted the back splash on the back of the east counter and this was marked as BH-26.

BH-27 was an impact point on the south wall by the southeast door to SCI-8. There were two fragments imbedded in the wall at this location, which were recovered as item #1583.

BH-28 was also on the south wall by the southeast door and was an impact point only.

Type of Report Crime Scene	Technician R. Lloyd	Date 05/16/99	J.C.S.O. File 99-7625	Page - 13 -
-------------------------------	------------------------	------------------	--------------------------	----------------

BH-29 and BH-30 appeared to be impact points on the ceiling tiles in the middle of the room but the projectile did not penetrate these tiles. The angle indicated by the gouge in the ceiling tile pointed back to the northwest door to SCI-8.

BH-31 and BH-32 are impact points in the upturned desk in front of the northwest door to SCI-8. BH-31 was an actual hole punched through the edge of the desk and BH-32 appeared to be an impact point only.

West Science Hallway

In the hallway south of SCI-8, by a mechanical room, two spent shotgun shells were found on the floor (items #1530 and 1531). Blood spatter was seen on the wall of the hallway across from Science office #1. This is at the junction with the south hallway running east and west. A sample was collected as Item #1532.

Science Office #1

Team Four next examined Science office #1, which is located on the south side of the building between SCI-3 and SCI-4. This office area has a door on the northwest corner of the room (opening onto the hallway); a door on the southeast corner (opening to SCI-4); and a door on the southwest corner (opening to SCI-3). Teachers' desks are along the west wall. There are two rows of equipment and bookshelves down the middle of the room and the sink along the east side.

It appears multiple shots were fired into this room through the hallway door window, including shotgun and 9 mm. An incendiary device was also ignited inside this room. A live 9mm cartridge was found outside the door to SCI-3 and three fired 9mm casings were found outside the door to the science office (items # 1533-1536).

The incendiary device consisted of a glass bottle with some type of flammable liquid. There was also a CO2 cartridge, matches, and lead fragments found in the debris (items #1587-1594). Burn deposits on the glass door to the Science office indicate that the device may have been stuck on the window of the door with the initiator (which would be the CO2 cartridge) filled with some type of flammable and/or

Type of Report Crime Scene	Technician R. Lloyd	Date 05/16/99	J.C.S.O. File 99-7625	Page - 14 -
-------------------------------	------------------------	------------------	--------------------------	----------------

explosive compound. Since a lid was found for the glass bottle but no wick or other fusing, it appears as though the CO2 cartridge may have been the intended initiator for this device. While there were burn deposits on the door window, it does not appear that the glass jar containing the flammable liquid actually broke until it hit the floor inside the room. This would suggest that perhaps the CO2 cartridge was attached to the device, which was attached to the window but the cartridge failed to explode and simply spewed burning debris from the top depositing it on the window. The window was subsequently broken with the device landing on the floor inside the room. It was noted that the CO2 cartridge was not ruptured. A small fire was apparently started but extinguished by someone using a dry chemical fire extinguisher.

The bookcases down the center of the office were impacted by projectiles with the path of the projectiles pointing back to the northwest door. This would put the projectiles on a southeast trajectory coming through the door of the office.

Team Four left the Science area at approximately 1700 hours and attended a briefing in the auditorium for all the crime scene investigation teams. At approximately 1800 hours, Team Four cleared from the school. Taken on 04/23/99 were photo rolls #13 through #20.

On Monday, April 26, 1999, Team Four returned to the scene at Columbine High School at approximately 0800 hours. There, the investigation of the scene inside Science office #1 was resumed. Photographs were taken to document the individual items of evidence collected and also more bullet holes and impact points inside the room. Evidence collected from the Science office #1 consisted of evidence items #1587 through #1614.

BH-33 was a large impact point on the west edge of the window frame for the door to Science office #1. This impact point would be consistent with a shotgun round.

BH-34 was an impact across the spine of the books on the second shelf unit to the south and the third shelf down from the top.

Type of Report Crime Scene	Technician R. Lloyd	Date 05/16/99	J.C.S.O. File 99-7625	Page - 15 -
-------------------------------	------------------------	------------------	--------------------------	----------------

BH-35, BH-36 and BH-37 represent the path of the projectile traveling southeast from the northwest corner of the room. This is a large hole skipping across the spine of a Sigma catalog and through the south end of the second shelf unit to the south (BH-35). BH-36 is a hole in a blue 3 ring binder at the north edge of the third shelf unit to the south which is a through and through hole leading to BH-37 which enters another 3 ring binder just to the south of the first. Within this second 3 ring binder was recovered a large lead fragment and other smaller fragments were found when the 3 ring binder was moved. These were recovered as item #1607 and would be consistent with a shotgun slug. Item #1606 may be fragments relating to this item (#1607) as they were recovered on the same shelf beneath BH-35. It was also noted that a single shotgun wad in three pieces was recovered from inside the room. These were items #1597, #1608 and #1610.

BH-38 was an impact on the end of the second shelf unit to the south and recovered in that area were two small lead fragments marked as item #1611.

BH-39 was a hole through the end of the second shelf unit to the south which when a probe was placed through the hole lined up with BH-41. BH-40 was a second hole through the end of that same shelf unit which related to BH-42. BH-41 was in the divider between the east and west shelf units as was BH-42. The projectile going through BH-39 and BH-41 was recovered as item #1614 (a lead fragment located in a culture tube box on a shelf on the east side of the room). The projectile from BH-40 and BH-42 was recovered as item #1613, another fragment located inside a second culture tube box on the east shelf units. Item #1614 was in the box on the fourth shelf up from the floor and item #1613 was in the box on the fifth shelf up from the floor. Both of these were on the second unit to the south on the east side of the room.

South Science Hallway

The Science area has a U-shaped hallway with two north/south segments, which are on the west and east sides and the bottom of the U is the east/west hallway on the south end of the Science area. On the north side of the hallway at the intersection with the eastern northwest

Type of Report Crime Scene	Technician R. Lloyd	Date 05/16/99	J.C.S.O. File 99-7625	Page - 16 -
-------------------------------	------------------------	------------------	--------------------------	----------------

hallway was an impact point marked as BH-44. BH-44 is a gouge in the wood molding on the northwest corner of the intersection with the south Science and the east Science hall. This would locate it at the southeast side of SCI-10 and kitty-corner (northwest) across the hall from SCI-6. SCI-6 is located in the southeast corner of the Science area (see diagrams).

BH-45 is a hole in the hallway wall just to the north of the doorway for SCI-6. This is a through and through penetration into SCI-6. BH-46 is a hole in a speaker mounted on east wall of SCI-6. The projectile went through the speaker and into the wall behind the speaker. This is labeled as BH-47. The projectile was subsequently recovered as item #1615.

Entryway-South Commons Area

Team Four returned to the area of the entryway for the commons area located at the southwest corner of the school. In looking at the south wall over the entryway, additional impact points were noted that possibly relate to the initial impact points located on the second floor above the entryway (BH-7, BH-8 and BH-9).

The impact labeled BH-48 was in the window frame of the windows over the south entry to the commons. This is an impact point with no penetration.

BH-49 was a hole in the glass window over the south entryway over the east set of doors. This window is a set of double pane glass and the projectile penetrated the northernmost pane but did not penetrate the southern pane. A projectile was recovered between the glass as item #1619.

BH-50 was in the frame of the window at the southeast corner on the east wall of the entryway. A projectile was recovered relating to this as item #1618 from inside the window frame.

A nail (item #1620) was found on the ledge of a column on the southeast corner at the top of the stairway from the commons area to the second or main level of the school. A possible impact point was noted on the wall south of where the evidence was located and marked as BH- 51. Again

Type of Report Crime Scene	Technician R. Lloyd	Date 05/16/99	J.C.S.O. File 99-7625	Page - 17 -
-------------------------------	------------------------	------------------	--------------------------	----------------

photographs and measurements were taken on all of the above items and impact points.

The rolls of film taken on this date included roll #21 through roll #39. Team Four cleared from the scene at Columbine High School at approximately 1810 hours on April 26, 1999.

Outside the Commons Area

On Tuesday, April 27, 1999, Team Four entered the scene at Columbine High School at approximately 0800 hours. Team Four and the other investigators attended a briefing in which the remaining items of evidence needing to be collected were discussed. Team Four was assigned to collect a fragment of a bullet found outside the school. This was labeled as item #1622 and was found outside the south commons area in the lawn just to the southeast of the entry doors. This was photographed and measured for the diagrams.

Science Room #7

The team then went to SCI-7 where witness reports had indicated that several people had made notes relating to the bombing within the school as they sat in the room waiting for rescuers. Numerous papers were seen in this area strewn on the floor at the front of the classroom, which would be the west side of the room. These papers were photographed and collected as item #1623.

Tech Conference Room

Team Four was also requested to photograph the Tech conference room, which is located on the east side of the Tech Lab area. This had not previously been documented. It was noted that on one of the write-on boards on the north side of the classroom were the words "The skool sood bee blown u.p.s."

Team Four Summary

The following rooms contained evidence collected by Team Four:

Science 3 Science 6 Science 7 Science 8
 Science Office #1 Chemical Storeroom Music 1
 Math 10 Science Hallways Commons Entrance Area

Type of Report Crime Scene	Technician R. Lloyd	Date 05/16/99	J.C.S.O. File 99-7625	Page - 18 -
-------------------------------	------------------------	------------------	--------------------------	----------------

The team cleared the following rooms with no evidence collected:

Science 1 Science2 Science 4 Science 5
 Science 9 Science 10 Science 11 Science 12
 Math 1 Math 2 Math 3 Math 4
 Math 5 Math 6 Math 7 Math 8
 Math 9 Math 11 Math Comp Math 13
 Language rooms, LA-1 through LA-12
 Social studies rooms, SS-1 through SS-10
 Drafting Technical Lab
 Southeast corner of auditorium

Evidence logs will be submitted by Jefferson County Sheriff's Office. Sketch information will be submitted separately. Photographic logs are included with this report.

The following is breakdown on the major evidence collected:

Fired bullets/fragments----- 55
 Fired 9mm casings----- 6
 Fired shotgun casing----- 4
 Shotgun wad components----- 7
 Live 9mm rounds----- 5
 Bomb/Incendiary----- 1

This is the end of the narrative report. The photo log follows the signature page.

JC-001-012441

Type of Report Crime Scene	Technician R. Lloyd	Date 05/16/99	J.C.S.O. File 99-7625	Page - 20 -
-------------------------------	------------------------	------------------	--------------------------	----------------

Team Four Photo Log

Roll # 1

1. Placard for roll #1
2. Overall door to science storage room, south side of hallway
3. Medium photograph of storage room door
4. Looking south through science storage room door
5. East/west hallway north of science storage room, looking west

6. Inside of storage room door
7. South from storage door doorway
8. Looking southwest in storage room, from NE corner
9. Looking south to north in science storage room
10. Looking northeast in science storage room

11. Looking east from west in science room
12. Looking west from south east in room
13. From classroom door into storage room, looking west
14. Sanders lower half
15. Sanders upper half, south to north

16. Overall of Sanders looking north
17. Sanders upper half facing east
18. Sanders right side
19. Sanders legs right side
20. Sanders bottom of shoes

21. Sanders, face
22. Sanders face close-up
23. Sanders mouth close-up
24. Wound to right side of Sanders

Roll # 2

1. Placard for roll # 2
2. Head and shoulders
3. Sanders mouth with scale
4. Mouth without scale
5. Sanders' front shoulder wound

Type of Report	Technician	Date	J.C.S.O. File	Page
Crime Scene	R. Lloyd	05/16/99	99-7625	- 21 -

Roll # 2, continued

6. Sanders' front shoulder wound with scale
7. Right shoe with scale
8. Left shoe with scale
9. Sanders, left side of head
10. Sanders, upper body left side

11. Door and one by two board
12. Midrange foot print on door
13. Door closing mechanism on door
14. Door closing mechanism on door frame
15. Both pieces of door closing mechanism

16. Shoe print on door
17. Shoe print on door with scale
18. Shoe print on door without flash
19. Shoe print on door with flash
20. Shoe print on door with flash and scale

21. Sanders, wound left rib area
22. Close-up left rib area of Sanders
23. Sanders, left hand
24. Sanders, right hand

Roll # 3

1. Placard for roll # 3
2. Overall of back of Sanders
3. Left rib area with scale
4. Upper left back shoulder of Sanders
5. Wound on base of left neck, with scale

6. Right shoulder wound, with scale
7. Sanders, wallet with identification: David Sanders, DOB: (102251)
8. Wallet, close-up
9. Hallway looking southeast
10. Hallway, outside storage room, blood stains on carpet

Type of Report	Technician	Date	J.C.S.O. File	Page
Crime Scene	R. Lloyd	05/16/99	99-7625	- 22 -

Roll # 3, continued

11. Blood stains with scale
12. North group of blood stains with scale
13. South group blood stains with scale
14. Blood trail looking east
15. Two pools of blood with scale

16. West pool with scale
17. East pool with scale
18. Tooth on floor east of science storage door
19. Tooth in relation to open science storage room door
20. Tooth in relation to open science storage room door with scale

21. Close-up of tooth with scale
22. Close-up of tooth without scale
23. Blood trail east of blood pools
24. Blood trail east of blood pools

Roll # 4

1. Placard for roll # 4
2. Right hand print in blood, hallway north of storeroom
3. Right hand print with scale
4. Right hand print without scale
5. Right hand print with scale, southeast impression

6. Right hand print without scale, southeast impression
7. Northeast handprint with scale
8. Northeast handprint without scale
9. Overall view of bloody handprints in hallway
10. Science hallway looking southeast

11. Science hallway looking southeast
12. Science hallway looking south
13. Science hallway to southwest
14. Door to science room # 1 (SCI-1)
15. Door knob with blood to SCI-1

16. Floor in front of SCI-1
17. North wall entry to SCI-1
18. Close-up blood spots in hallway outside SCI-1
19. Blood drops with scale, wall south of SCI-1 door
20. Blood on corner with scale, wall south of SCI-1 door

Type of Report	Technician	Date	J.C.S.O. File	Page
Crime Scene	R. Lloyd	05/16/99	99-7625	- 23 -

Roll # 4, continued

21. Overall door frame to SCI-1
22. Blood on door frame to SCI-1
23. Blood on door frame to SCI-1 with scale
24. West Science hallway looking south

Roll # 5

1. Placard for roll # 5
2. Door to science office 1
3. Hallway looking southeast toward science office
4. Fired shotgun shell outside mechanical room
5. Blood on hallway wall, intersection of hallways

6. Blood on wall with scale
7. Overall science room #3 (SCI-3)
8. Fired cartridge case outside SCI-3
9. Doorway to science office 1
10. Looking into science office 1

11. Fired 9mm casing, behind science office 1 door
12. Fired shell casing, east of science door 1
13. Looking south into SCI-3
14. Blood pool, east wall, SCI-3
15. Looking north, SCI-3

16. Looking west, SCI-3
17. Looking west, SCI-3
18. Close-up-portion of Sanders shirt on floor of SCI-3
19. Close-up-portion of Sanders shirt, close-up
20. Overall of tooth on floor, SCI-3

21. Overall of tooth in SCI-3, close-up
22. Close-up of tooth with scale
23. Eyeglasses on desk, north side of SCI-3
24. Close-up of eyeglasses

Roll # 6

1. Placard for roll # 6
2. West side of SCI-3 looking south
3. Sign, "1 BLEEDING TO DEATH"
4. Close-up of sign

Type of Report Crime Scene	Technician R. Lloyd	Date 05/16/99	J.C.S.O. File 99-7625	Page - 25 -
-------------------------------	------------------------	------------------	--------------------------	----------------

Roll # 7, continued

14. # 1511, match stick, close-up
15. # 1512, match stick, close-up

16. # 1513, carpet with blood and fragments, close-up
17. # 1514, carpet with blood and fragments, close-up
18. # 1515, metal fragment, close-up
19. # 1516, carpet with blood, close-up
20. # 1517, tooth, close-up

21. # 1518, Advil pill, close-up
22. # 1519, nail, close-up
23. # 1520, live 9mm cartridge, close-up
24. # 1521, nail with duct tape, close-up

Roll # 8

1. Placard for roll # 8
2. # 1522, nail, close-up
3. # 1523, metal nut, close-up
4. # 1524, belt buckle, close-up
5. # 1525, fired shotgun shell, close-up

6. # 1526, fired 9mm casing, close-up
7. # 1527, fired shotgun shell, close-up
8. # 1528, fired 9mm casing, close-up
9. # 1529, fired 9mm casing, close-up
10. # 1530, fired shotgun shell, close-up

11. # 1531, fired shotgun shell, close-up
12. # 1532, blood (on wall), close-up
13. # 1533, live 9mm cartridge, close-up
14. # 1534, fired 9mm casing, close-up
15. # 1535, fired 9mm casing, close-up

16. # 1536, fired 9mm casing, close-up
17. # 1537, tooth, close-up
18. # 1538, partial shirt, close-up
19. # 1539, eyeglasses, close-up
20. # 1540, sign "1 BLEEDING TO DEATH", close-up

21. # 1541, nail, close-up

Type of Report Crime Scene	Technician R. Lloyd	Date 05/16/99	J.C.S.O. File 99-7625	Page - 26 -
-------------------------------	------------------------	------------------	--------------------------	----------------

Roll # 8, continued

22. # 1542, nail, close-up
23. # 1543, bullet fragment, close-up
24. # 1544, bomb fragments, close-up

Roll # 9

1. Placard for roll # 9
2. Science storage room west wall with cabinet and sink
3. Science storage room west wall, behind cabinet
4. Science storage room west wall, close-up of hole
5. Science storage room west wall, close-up with scale

6. Science storage room, west wall hole with scale
7. # 1545, nail, close-up
8. # 1546, nail, close-up
9. # 1547, live 9mm cartridge, close-up
10. Overall, windows at south end of west hallway

11. Overall, west storage room wall, outside over entryway
12. Overall, west storage room wall, hole, other side of BH 2- 6
13. Overall, windows over entry to commons
14. Overall windows, south wall to west end of hall, looking from storage room
15. Overall, south side to west end of hall, with placards

16. East half, south window area
17. West half, south window area
18. Bullet holes (BH) 1 and 2
19. BH 1, with scale
20. BH 2, with scale

21. BH 3, 4, and 5
22. BH 3, with scale
23. BH 4, with scale

Roll # 10

1. Placard for roll # 10
2. BH 5, frame under poster
3. BH 5, with scale
4. BH 6 and 7

Type of Report Crime Scene	Technician R. Lloyd	Date 05/16/99	J.C.S.O. File 99-7625	Page - 27 -
-------------------------------	------------------------	------------------	--------------------------	----------------

Roll # 10, continued

5. BH 6, with scale
6. BH 7, with scale
7. BH 8 and 9
8. BH 8, with scale
9. BH 9, with scale
10. BH 10, (nail strike)
11. BH 10, with scale
12. BH 11 and 12
13. BH 11, with scale
14. BH 12, with scale
15. BH 13 and 14, item # 1548, metal fragment
16. BH 13, with scale
17. BH 14, with scale
18. # 1548, metal fragment, with scale
19. BH 15
20. BH 15, with scale
21. South wall with bullet probes, looking southeast
22. South wall with bullet probes, looking southwest
23. Overall south wall with bullet probes
24. South wall looking from storage room

Roll # 11

1. Placard for roll # 11
2. South wall with probes looking up from commons area
3. West wall storage and south wall (up from cafeteria)
4. West wall of storage room from cafeteria
5. Hole west wall of storage room from inside room
6. Hole in west wall inside storage room
7. Hole in west wall showing bullet hole in stud
8. Hole in west wall showing bullet hole in stud
9. Bullet inside west wall of storage room
10. # 1549, bullet fragment, in wall
11. # 1549, bullet fragment, in wall
12. BH 12 with drywall removed (no flash)
13. BH 12 close-up

Type of Report Crime Scene	Technician R. Lloyd	Date 05/16/99	J.C.S.O. File 99-7625	Page - 28 -
-------------------------------	------------------------	------------------	--------------------------	----------------

Roll # 11, continued

14. #1550, bullet fragment from BH 12
15. #1550, with scale
16. Bullet in insulation from BH 14 (no flash)
17. Bullet in insulation from BH 14 with scale
18. # 1551, bullet, with scale
19. # 1552, bullet fragment, south wall under window (overall)
20. # 1552, bullet fragment, close-up
21. # 1552, bullet fragment, with scale
22. Hole in drywall, west wall of storage room, behind shelves
23. Hole in drywall, (outside wall)
24. # 1553, bullet inside wall

Roll # 12

1. Placard for roll # 12
2. # 1553, bullet, in wall, science storage room
3. Door to SCI-8, looking SE, door open
4. Door to SCI-8, looking SE, door closed
5. Looking south into SCI-8 with bullet hole in table
6. Looking south into SCI-8, close-up of hole
7. Looking south into SCI-8, with scale and bullet hole
8. Looking south into SCI-8, with hole with scale
9. Looking southeast overall of science room 8
10. Looking southwest overall, science room 8
11. Looking northwest overall, science room 8
12. Looking northeast overall of science room 8
13. Music 1 door looking northeast
14. Music room 1 looking northwest overall
15. Looking northwest into music room 1
16. Looking southwest overall into music 1
17. Looking northwest overall into music 1
18. Medium shot of back packs and video camera, music room 1
19. Close-up shot of back packs and video camera, music room 1
20. Close-up shot of back packs and video camera, music room 1
21. #1554-1557, backpack, video camera, hat/shirt, notebook
22. Doorway to math 10

Type of Report	Technician	Date	J.C.S.O. File	Page
Crime Scene	R. Lloyd	05/16/99	99-7625	- 29 -

Roll # 12, continued

23. Looking northwest into math 10
24. Looking northeast into math 10

Roll # 13

1. Placard for roll # 13
2. Math 10, looking southeast
3. Math 10, looking southwest
4. Eric Veik's desk, looking SE
5. Eric Veik's desk, looking east

6. Eric Veik's desk, from top
7. Eric Veik's desk, from top
8. Eric Veik's desk, close-up
9. Eric Veik's desk, with camera bag close-up
10. Eric Veik's desk, Target bag

11. Eric Veik's desk
12. Looking northwest from Veik's desk, in math 10
13. #1559-1562, camera case, Target bag, backpack, paper and pencil
14. North doorway into SCI-8
15. Doorway looking south in SCI-8

16. Inside SCI-8, looking south
17. Inside SCI-8 looking east
18. From inside SCI-8 looking north
19. # 1563, bullet fragment
20. # 1563, with scale

21. # 1564, lead fragment
22. # 1564, with scale
23. # 1565, bullet fragment
24. # 1565, with scale

Roll # 14

1. Placard for roll # 14
2. # 1566, lead fragment
3. # 1566, with scale
4. # 1567, bullet fragment
5. # 1567, with scale

Type of Report Crime Scene	Technician R. Lloyd	Date 05/16/99	J.C.S.O. File 99-7625	Page - 30 -
-------------------------------	------------------------	------------------	--------------------------	----------------

Roll # 14, continued

6. # 1568, shotgun wad fragment
7. # 1568, with scale
8. # 1569, shotgun wad fragment
9. # 1569, with scale
10. # 1570, bullet fragment

11. # 1570, with scale
12. # 1571, bullet fragment
13. # 1571, with scale
14. # 1572, shotgun wad fragment
15. # 1572, with scale

16. # 1573, lead fragment
17. # 1573, with scale
18. # 1574, bullet fragment
19. # 1574, with scale
20. # 1575, bullet fragment

21. # 1575, with scale
22. # 1576, bullet fragment
23. # 1576, with scale
24. Overall east wall of SCI-8

Roll # 15

1. Placard for roll # 15
2. # 1577, bullet fragment, in BH 21
3. # 1577, with scale
4. # 1578, bullet fragment
5. # 1578, with scale

6. # 1579, shotgun wad fragment
7. # 1579, with scale
8. # 1580, lead fragment (shot pellet)
9. # 1580, with scale
10. BH 16

11. BH 16 with scale
12. BH 17
13. BH 17 with scale
14. BH 18
15. BH 18 with scale

Type of Report	Technician	Date	J.C.S.O. File	Page
Crime Scene	R. Lloyd	05/16/99	99-7625	- 31 -

Roll # 15, continued

16. BH 19
17. BH 19 with scale
18. BH 20
19. BH 20 with scale
20. BH 23

21. BH 23 with scale
22. BH 21 (w/# 1577)
23. BH 21 with scale
24. BH 22

Roll # 16

1. Placard for roll # 16
2. BH 22 with scale
3. BH 24
4. BH 24 with scale
5. BH 24 exit

6. BH 24 exit with scale
7. BH 25
8. BH 25 with scale
9. BH 25 exit
10. BH 26

11. BH 26 with scale
12. BH 27
13. BH 27 with scale
14. BH 28
15. BH 28 with scale

16. Overall ceiling SCI 8 looking northwest
17. Overall ceiling SCI 8 looking southeast
18. BH 29, in ceiling
19. BH 29 with scale
20. BH 30, in ceiling

21. BH 30 with scale
22. BH 21 and # 1577, bullet fragment
23. # 1577, bullet fragment
24. # 1577, with scale

Type of Report Crime Scene	Technician R. Lloyd	Date 05/16/99	J.C.S.O. File 99-7625	Page - 32 -
-------------------------------	------------------------	------------------	--------------------------	----------------

Roll # 17

1. Placard for roll # 17
2. BH 17 with probe looking east with no flash
3. BH 17 with probe looking east with flash
4. BH 17 with probe looking overhead
5. BH 20 with probe, looking east

6. BH 20 with probe from below
7. # 1581, bullet fragment
8. East wall, SCI-8, looking north with no flash
9. East wall of SCI-8 looking north with flash
10. # 1582, bullet fragment, looking south

11. # 1582, bullet fragment, looking south
12. # 1582, with scale
13. # 1583, lead fragment
14. # 1584, bullet fragment, in insulation
15. # 1584, with scale

16. Science office 3 chemical supply, looking north
17. Science office 3 chemical supply, looking northwest
18. Science office 3 chemical supply, looking south
19. Science office 3 chemical supply, looking east
20. Science office 3 BH 17 exit

21. Science office 3 BH 17 exit with scale
22. Science office 3 shelf area south of BH 17
23. Science office 3 shelf area west of bullet
24. # 1585, bullet, from BH 17

Roll # 18

1. Placard for roll # 18
2. # 1585, bullet from BH 17 with scale
3. Science office 3 with dent in cabinet
4. # 1586, lead fragment on top of towel dispenser, SCI-8
5. # 1586, with scale

6. Looking south at science office 1
7. Looking south at science office 1 with door closed
8. Close-up of science office 1 door glass
9. BH 33
10. BH 33 with scale

Type of Report Crime Scene	Technician R. Lloyd	Date 05/16/99	J.C.S.O. File 99-7625	Page - 33 -
-------------------------------	------------------------	------------------	--------------------------	----------------

Roll # 18, continued

11. Burnt deposit on science office 1 door exit
12. Science office 1 door looking east
13. From science office 1 door looking east
14. Looking north from south end, science office 1
15. Looking north from south end, east half of office

16. Looking north from north end, looking at east half
17. Burn pattern on floor looking west
18. Burn pattern on floor, looking north
19. Burn pattern on floor, from overhead
20. Looking east from doorway

21. North bookcase, west side
22. North bookcase, close-up of cloth vest hanging on shelves
23. North bookcase, holes in bookcase behind vest
24. South end, north bookcase

Roll # 19

1. Placard for roll # 19
2. North desk, science office 1
3. South desk, science office 1
4. East shelving unit, looking to west bullet holes
5. East shelving unit, looking to west, upper half

6. East shelving unit, looking west, lower portion
7. Science office 1, outside of door, number markers in hallway
8. Science office 1, number markers on floor
9. # 1587, match stick
10. # 1587, with scale

11. # 1588, 2 match sticks
12. # 1588, with scale
13. # 1589, lead fragment
14. # 1589, with scale
15. # 1590, bullet fragment

16. # 1590, with scale
17. Burn area with scale, showing # 1589 - # 1594
18. # 1592, CO2 cartridge
19. # 1592, CO2 cartridge, with scale
20. # 1593, lead fragment

Type of Report Crime Scene	Technician R. Lloyd	Date 05/16/99	J.C.S.O. File 99-7625	Page - 34 -
-------------------------------	------------------------	------------------	--------------------------	----------------

Roll # 19, continued

21. # 1593, lead fragment, with scale
22. # 1595, bullet fragment
23. # 1595, with scale
24. Overall photo of items, # 1596, # 1597 and # 1598

Roll # 20

1. Placard for roll # 20
2. # 1596, lead fragments
3. # 1596, with scale
4. # 1597, shotgun wad fragment
5. # 1597, with scale

6. # 1598, lead fragment
7. # 1598, with scale
8. # 1599, lead fragment
9. # 1599, with scale
10. # 1600, bullet fragment (piece of copper jacket)

11. # 1600, with scale
12. # 1601, lead fragment
13. # 1601, with scale
14. # 1602, lead fragment
15. # 1602, with scale

16. # 1603, blue vest
17. # 1603, with scale
18. Front of box with bullet hole from # 1604, bullet fragment
19. Side of box with bullet hole from # 1604
20. # 1604, bullet fragment, from inside box

21. # 1604, with scale
22. # 1605, lead fragments, overall
23. # 1605, no scale, close-up
24. # 1605, with scale

Type of Report	Technician	Date	J.C.S.O. File	Page
Crime Scene	R. Lloyd	05/16/99	99-7625	- 35 -

Roll # 21

1. Placard for roll # 21
2. # 1600, piece of copper jacket, overall
3. # 1600, with scale
4. # 1601, lead fragment, overall
5. # 1601, with scale

6. # 1602, lead fragment, overall
7. # 1602, with scale
8. # 1603, blue vest
9. # 1604, bullet fragment from inside box
10. # 1604, with scale

11. # 1605, bullet fragment
12. # 1605, with scale
13. # 1606, lead fragments, on shelf
14. # 1606, with scale
15. Bullet holes from # 1607, in shelf unit
16. Bullet holes from # 1607, in notebooks
17. # 1607, piece of shotgun slug, inside book
18. # 1607, with scale inside book
19. # 1607, second piece of slug on shelf
20. # 1607, second piece of slug, with identification tag

21. # 1607, second piece of slug, with scale
22. # 1608, lead fragment on floor
23. # 1608, with scale
24. # 1609, shotgun wad fragment, overall

Roll # 22

1. Placard for roll # 22
2. # 1609, shotgun wad fragment, in tray
3. # 1609, with scale (tray moved for photo)
4. # 1610, shotgun wad fragment (behind window shade)
5. # 1610, overall with shades up

6. # 1610, with scale
7. BH 34, 35, 36 and 37 (from # 1607)
8. BH 35 exit
9. BH 35 entry with scale on shelving
10. Bullet holes in south end shelving unit

Type of Report Crime Scene	Technician R. Lloyd	Date 05/16/99	J.C.S.O. File 99-7625	Page - 36 -
-------------------------------	------------------------	------------------	--------------------------	----------------

Roll # 22, continued

11. Bullet holes in south end shelving with markers (BH 38-40 and 43)
12. Bullet holes in divider between shelves (BH 41 and 42)
13. BH 38 with scale
14. BH 39 and 40 with scale
15. Exits for BH 39 and 40

16. Exits for BH 39 and 40, with scale
17. BH 34, 38, 39, 40 and 43, with probes, looking east
18. BH, 34, 38, 39, 40 and 43, looking from doorway
19. BH 34 and 35 with a probe
20. # 1611, lead fragments, overall

21. # 1611, lead fragments, close-up
22. # 1611, with scale
23. # 1612, bullet fragments, inside book
24. # 1612, with scale

Roll # 23

1. Placard for roll # 23
2. East side of second shelf, exit for BH 42
3. East side, second shelf, exit for BH 41
4. BH 42 exit with marker
5. BH 41 exit with marker

6. Inside (close-up) culture tube box (BH 42 continued)
7. # 1613, bullet fragment (from BH 42)
8. # 1613, with scale
9. Small culture tube box (BH 41 continued)
10. Inside (close-up) culture tube box

11. Dividers inside small culture tube box
12. # 1614, lead fragment (from BH 42)
13. # 1614, with scale (removed from box)
14. South science hall, looking east outside SCI-5
15. Corner of hall, west of SCI-10

16. Close-up BH 44
17. Close-up BH 44 with scale
18. Midrange of BH 44, 45, and 46
19. Midrange of BH 44, 45, and 46 with scale
20. BH 45 no scale

Type of Report	Technician	Date	J.C.S.O. File	Page
Crime Scene	R. Lloyd	05/16/99	99-7625	- 37 -

Roll # 23, continued

21. BH 45 with scale
22. Exit for BH 45, overall
23. Bullet 45 exit, mid range
24. BH 45, exit with scale

Roll # 24

1. Placard for roll # 24
2. SCI-6 looking southeast
3. SCI-6, looking southwest
4. SCI-6, looking northwest
5. SCI-6, looking northeast

6. BH 46, in speaker, overall looking east
7. BH 46, midrange
8. BH 46, close-up with scale
9. BH 46, and BH 47
10. Exit for BH 46

11. BH 47, midrange
12. BH 47 with scale
13. Overalls, east pillar, SCI-6
14. # 1615, bullet, inside wall, midrange (from BH 44-47)
15. # 1615, close-up

16. # 1615, with scale
17. # 1616, bullet fragment (from BH 6), overall, inside window frame
18. # 1616, bullet inside window frame
19. # 1617, live 9mm cartridge, overall looking east
20. # 1617, live 9mm cartridge, midrange looking east

21. # 1617, close-up without scale
22. # 1617, close-up with scale
23. Looking south at upper window with bullet hole, south of cafeteria
24. Looking south at upper window with bullet holes, south of cafeteria

Roll # 25

1. Placard for roll # 25
2. Broken window and impact on frame
3. Overall impacts on window south side of cafeteria (BH 48-49)
4. Photo of bullet, between glass, south of cafeteria (#1619)

Type of Report Crime Scene	Technician R. Lloyd	Date 05/16/99	J.C.S.O. File 99-7625	Page - 38 -
-------------------------------	------------------------	------------------	--------------------------	----------------

Roll # 25, continued

5. Looking south, BH 48, 49, and 50 south of cafeteria
6. Hole in window frame, east side of south commons entry
7. # 1618, bullet fragment, from BH 50
8. # 1618, with marker
9. # 1618, with marker, out of wall
10. # 1618, with scale
11. # 1619, bullet fragments (from BH 49), with marker
12. # 1619, with label from second floor
13. # 1619, with scale, removed from window
14. BH 51 overall, looking south
15. BH 51 close-up
16. BH 51 with scale
17. # 1620, nail, overall looking north west
18. # 1620, close-up
19. # 1620, with scale
20. Entrance music store room
21. Interior of music room looking northwest
22. Interior of music room, looking northeast
23. Interior of music room, looking southeast
24. Interior of music room, looking southeast

Roll # 26

1. Placard for roll # 26
2. Storage room, next to vocal music 1
3. Interior of storage room, looking northwest
4. Interior of storage room, looking northeast
5. Interior of storage room, looking southeast
6. Interior of storage room, looking southwest
7. Auditorium hallway, looking north
8. Doorway to music 3
9. Interior of music 3, looking northwest
10. Interior of music 3, looking northeast
11. Interior of music 3, looking southeast
12. Interior of music 3, looking southwest
13. Exterior science mechanical, next to SCI-4

Type of Report Crime Scene	Technician R. Lloyd	Date 05/16/99	J.C.S.O. File 99-7625	Page - 39 -
-------------------------------	------------------------	------------------	--------------------------	----------------

Roll # 26, continued

14. Interior of science mechanical, looking southeast
15. Interior of science mechanical, looking north

16. Exterior of science mechanical across from SCI-4
17. Interior of science mechanical from south side
18. Exterior of SCI-4, with door
19. Interior of SCI-4, looking southeast
20. Interior of SCI-4, looking northeast

21. Interior of SCI-4, looking northwest
22. Interior of SCI-4, looking southwest
23. Exterior of SCI-5
24. Interior of SCI-5, looking southeast

Roll # 27

1. Placard for roll # 27
2. Interior of SCI-5, looking northeast
3. Interior of SCI-5, looking northwest
4. Interior of SCI-5, looking southwest
5. Exterior of science office 2

6. Interior, science office 2, east looking west
7. Interior, science office 2, west end looking north
8. Interior, science office 2, east end
9. Interior, science office 3, north end
10. Exterior room adjacent to science office 2

11. Faculty lavatory, storage room adjacent to science office 2
12. Exterior SCI-7
13. Interior SCI-7 looking northeast
14. Interior SCI-7 looking northwest
15. Interior SCI-7 looking southwest

16. Interior SCI-7 looking southeast
17. Exterior north door, SCI-9
18. Interior SCI-9, looking southwest
19. Interior SCI-9, looking southeast
20. Interior SCI-9, looking northeast

21. Interior SCI-9, looking northwest
22. Exterior, SCI-10

Type of Report Crime Scene	Technician R. Lloyd	Date 05/16/99	J.C.S.O. File 99-7625	Page - 40 -
-------------------------------	------------------------	------------------	--------------------------	----------------

Roll # 27, continued

23. Interior, SCI-10, looking northwest
24. Interior, SCI-10, looking southwest

Roll # 28

1. Placard for roll # 28
2. Interior, SCI-10, looking southeast
3. Interior, SCI-10, looking northeast
4. Exterior, SCI-11
5. Interior, SCI-11, looking northwest

6. Interior, SCI-11, looking southwest
7. Interior, SCI-11, looking southeast
8. Interior, SCI-11, looking northeast
9. Exterior, SCI-12
10. Interior, SCI-12, looking northeast

11. Interior, SCI-12, looking northwest
12. Interior, SCI-12, looking southwest
13. Interior, SCI-12, looking southeast
14. Officer adjacent to SCI-12
15. Interior of office, adjacent to SCI-12, looking west

16. Office interior looking east
17. Office interior looking west
18. Office interior looking north
19. Office interior looking south
20. Yearbook room exterior

21. Yearbook room looking southeast
22. Yearbook room looking northeast
23. Yearbook room looking northwest
24. Yearbook room looking southwest

Roll # 29

1. Placard for roll # 29
2. Yearbook Publishing office doorway
3. Yearbook Publishing office looking southwest
4. Yearbook Publishing office looking southeast
5. Yearbook Publishing office looking northwest

Type of Report Crime Scene	Technician R. Lloyd	Date 05/16/99	J.C.S.O. File 99-7625	Page - 42 -
-------------------------------	------------------------	------------------	--------------------------	----------------

Roll # 30, continued

16. Exterior of math # 7
17. Interior of math 7, looking southeast
18. Interior of math 7, looking northeast
19. Interior of math 7, looking northwest
20. Interior of math 7, looking southwest

21. Exterior of math 5
22. Interior of math 5, looking southeast
23. Interior of math 5, looking northeast
24. Interior of math 5, looking northwest

Roll # 31

1. Placard for roll # 31
2. Interior of math 5 looking southwest
3. Exterior of math 4
4. Interior of math 4 looking southeast
5. Interior of math 4 looking northeast

6. Interior of math 4 looking northwest
7. Interior of math 4 looking southwest
8. Exterior of math 3
9. Interior of math 3, looking southeast
10. Interior of math 3, looking southwest

11. Interior of math 3, looking northwest
12. Interior of math 3, looking northeast
13. Exterior of math 2
14. Interior of math 2 looking southeast
15. Interior of math 2, looking southwest

16. Interior of math 2, looking northwest
17. Interior of math 2, looking northeast
18. Exterior of math 1
19. Interior of math 1, looking northeast
20. Interior of math 1, looking northwest

21. Interior of math 1, looking southwest
22. Interior of math 1, looking southeast
23. East math hallway, looking north
24. Bathroom for Faculty, math area

Type of Report Crime Scene	Technician R. Lloyd	Date 05/16/99	J.C.S.O. File 99-7625	Page - 43 -
-------------------------------	------------------------	------------------	--------------------------	----------------

Roll # 32

1. Placard for roll # 32
2. Exterior, LA-13
3. Interior of LA-13, looking southwest
4. Interior of LA-13, looking southeast
5. Interior of LA-13, looking northeast

6. Interior of LA-13, looking northwest
7. Interior of office adjacent to LA-13, looking northeast
8. Interior of office, adjacent to LA-13, looking southeast
9. Interior of office, adjacent to LA-13, looking southwest
10. Exterior of MRC room

11. Interior of MRC room, looking northeast
12. Interior of MRC room, looking southeast
13. Interior of MRC room, looking southwest
14. Interior of MRC room, looking northwest
15. Math office adjacent to MRC room

16. Interior of math office, looking northwest
17. Interior of math office, looking southwest
18. Interior of math office, looking southeast
19. Interior of math office, looking northeast
20. Telephone room, math area

21. Mechanical room in math area
22. Math computer room
23. Math computer room looking southeast
24. Math computer room looking northeast

Roll # 33

1. Placard for roll # 33
2. Math computer room looking northwest
3. Math computer room, looking southwest
4. Janitor's closet math area
5. East bathroom in math area

6. East bathroom in math area, men's room, looking northeast
7. East bathroom in math area, men's room looking southwest
8. East bathroom in math area, women's room, looking northwest

Type of Report Crime Scene	Technician R. Lloyd	Date 05/16/99	J.C.S.O. File 99-7625	Page - 44 -
-------------------------------	------------------------	------------------	--------------------------	----------------

Roll # 33, continued

9. East bathroom in math area, women's room, looking southeast
10. English hallway to front door looking north
11. Language Arts south hallway (LA3 -10), looking east
12. LA-4 exterior view
13. LA-4, interior, looking southeast
14. LA-4, interior, looking northeast
15. LA-4, interior, looking northwest
16. LA-4, interior, looking southwest
17. Exterior LA-5
18. Interior, LA-5, looking southwest
19. Interior, LA-5, looking southeast
20. Interior, LA-5, looking northeast
21. Interior, LA-5, looking northwest
22. Exterior, LA-6
23. Interior, LA-6, looking southwest
24. Interior, LA-6, looking northwest

Roll # 34

1. Placard for roll # 34
2. Exterior of LA-3
3. LA-3, looking southwest
4. LA-3, looking northwest
5. LA-3, looking northeast
6. LA-3, looking southeast
7. Exterior of LA-room 10
8. LA-room 10, looking northwest
9. LA-room 10, looking northeast
10. LA-room 10, looking southeast
11. LA-room 10, looking southwest
12. LA-9, exterior
13. LA-9, looking northeast
14. LA-9, looking southeast
15. LA-9, looking southwest

Type of Report Crime Scene	Technician R. Lloyd	Date 05/16/99	J.C.S.O. File 99-7625	Page - 45 -
-------------------------------	------------------------	------------------	--------------------------	----------------

Roll # 34, continued

16. LA-room 9, looking northwest
17. Language-composition room
18. Language-composition room, looking south
19. Language-composition room, looking north
20. Possible storage room, (no marker or name) east of LA-6

21. Storage room, looking southeast
22. Storage room, looking southwest
23. Storage room, looking northwest
24. Storage room, looking northeast
25. Conference room 1

26. Conference room 1, looking northwest
27. Conference room 1, looking southeast
28. Storage room across from LA-6
29. Storage room, looking west
30. Storage room, looking east

31. Classroom, south of SS-8 (LA-8)
32. Classroom (LA-8), looking southeast
33. Classroom (LA-8), looking southwest
34. Classroom (LA-8), looking northwest
35. Classroom (LA-8), looking northeast

36. Storage room

ROLL # 35

1. Placard for roll # 35
2. East Language Arts hallway, looking south
3. North Language Arts hallway, looking west
4. Language Arts north hallway, east exit
5. Exterior social studies (SS) 8

6. Interior SS-8 looking northeast
7. Interior SS-8, looking southeast
8. Interior SS-8, looking southwest
9. Interior SS-8, looking northwest

10. Exterior, SS-7
11. Interior SS-7, looking northwest
12. Interior SS-7, looking southwest

Type of Report	Technician	Date	J.C.S.O. File	Page
Crime Scene	R. Lloyd	05/16/99	99-7625	- 46 -

Roll # 35, continued

13. Interior SS-7, looking southeast
14. Interior SS-7, looking northeast
15. Exterior conference room 1, adjacent to SS-7

16. Interior of conference 1, looking northwest
17. Interior of conference 1, looking northeast
18. Interior of conference 1, looking southeast
19. Exterior of conference 2, adjacent to SS-7
20. Interior of conference 2, looking northwest

21. Interior of conference 2, looking southeast
22. Interior of conference 2, looking southwest
23. Exterior of SS-6
24. Interior of SS-6, looking northwest

Roll # 36

1. Placard for roll # 36
2. Social studies office
3. Interior, social studies office looking southwest
4. Interior social studies office looking northwest
5. Interior social studies office looking northeast

6. Interior social studies office looking southeast
7. Storage room across from social studies office
8. Storage room looking northeast
9. Storage room looking southeast
10. Storage room looking southwest

11. Storage room looking northwest
12. Exterior, SS-9
13. SS-9, looking southeast
14. SS-9, looking southwest
15. SS-9, looking northwest

16. SS-9, looking northeast
17. Room west of SS-9 (SS-10)
18. Room (SS-10) looking southwest
19. Room (SS-10) looking northwest
20. Room (SS-10) looking northeast

21. Room (SS-10) looking southeast

Type of Report	Technician	Date	J.C.S.O. File	Page
Crime Scene	R. Lloyd	05/16/99	99-7625	- 47 -

Roll # 36, continued

22. Exterior, SS-4
23. SS-4, looking northwest
24. SS-4, looking northeast
25. SS-4, looking southeast

26. SS-4, looking southwest
27. Exterior, SS-1
28. SS-1, looking northwest
29. SS-1, looking northeast
30. SS-1, looking southwest

31. SS-1, looking southeast
32. Faculty bathroom
33. Bathroom looking northwest
34. Bathroom looking northeast
35. Conference room

36. Conference room looking west
37. Conference room looking east

Roll # 37

1. Placard for roll # 37
2. SS-6, looking southwest
3. SS-6, looking southeast
4. SS-6, looking northeast
5. Exterior of SS-5

6. SS-5, looking northeast
7. SS-5, looking southeast
8. SS-5, looking northwest
9. Social studies, 5, looking southwest
10. SS-5, looking southeast

11. Northwest social studies hall, looking east
12. Northwest social studies hall, looking west
13. Exterior of SS-3
14. SS-3, looking northeast
15. SS-3, looking northwest

Type of Report Crime Scene	Technician R. Lloyd	Date 05/16/99	J.C.S.O. File 99-7625	Page - 48 -
-------------------------------	------------------------	------------------	--------------------------	----------------

Roll # 37, continued

16. SS-3, looking southwest
17. SS-3, looking southeast
18. Exterior of SS-2
19. SS-2, looking northwest
20. SS-2, looking southwest

21. SS-2, looking southeast
22. SS-2, looking northeast
23. West social studies hall looking south
24. South social studies hall looking east
25. Exterior of LA-12

Roll # 38

1. Placard for roll # 38
2. ERC room
3. ERC, looking southwest
4. ERC, looking northwest
5. ERC, looking northeast

6. ERC, looking southeast
7. Northwest doorway exit
8. Exterior, Publications room
9. Publications room, looking southeast
10. Publications room, looking northwest

11. Publication room, looking northeast
12. Exterior, LA-2
13. LA-2, looking southeast
14. LA-2, looking northeast
15. LA-2, looking northwest

16. LA-2, looking northeast

ROLL # 39

1. Placard for roll # 39
2. Interior of LA-12, looking northeast
3. Interior of LA-12, looking northwest
4. Interior of LA-12, looking southwest
5. Interior of LA-12, looking southeast

Type of Report Crime Scene	Technician R. Lloyd	Date 05/16/99	J.C.S.O. File 99-7625	Page - 49 -
-------------------------------	------------------------	------------------	--------------------------	----------------

Roll # 39, continued

6. Exterior of LA-11
7. LA-11, looking southeast
8. LA-11, looking northeast
9. LA-11, looking northwest
10. LA-11, looking southwest

11. Exterior, LA-1
12. LA-1, looking southwest
13. LA-1, looking southeast
14. LA-1, looking northeast
15. LA-1, looking northwest

16. Technical laboratory looking northwest
17. Technical laboratory, looking northeast
18. Technical laboratory, looking southeast
19. Technical laboratory, looking southwest
20. Drafting room looking northeast

21. Drafting room looking southeast
22. Drafting room looking southwest
23. Drafting room looking northwest
24. Conference room 2 looking southwest

Roll # 40

1. Placard for roll # 40
2. South side of school, commons area
3. South side of school, commons area
4. # 1622, bullet fragment (copper jacket) close-up, no placard
5. # 1622, close-up with placard

6. # 1622, close-up with scale
7. North door to SCI-7
8. West end of SCI-7, looking south
9. West end of SCI-7, looking north
10. SCI-7 with papers on floor

11. SCI-7 with papers on floor
12. SCI-7 with papers on floor
13. SCI-7 papers on desk next to projector
14. # 1623, papers on floor
15. Door to technical lecture room

Type of Report Crime Scene	Technician R. Lloyd	Date 05/16/99	J.C.S.O. File 99-7625	Page - 50 -
-------------------------------	------------------------	------------------	--------------------------	----------------

Roll # 40, continued

16. Technical lecture room, looking southwest
17. Technical lecture room, looking southeast
18. Technical lecture room, looking northwest
19. Technical lecture room, looking northeast
20. Technical lecture room, dry erase board on north wall
21. Writing on west side of dry erase board
22. Writing on east side of dry erase board
23. Copy room, technical laboratory, looking southwest
24. Technical laboratory, looking from southwest to northeast

END OF PHOTOGRAPHIC LOG, TEAM FOUR

RH/rhl
05-25-99

Amended:
SDA
02-22-00

JC-001-012472

Type of Report Crime Scene	Technician R. Lloyd	Date 05/16/99	J.C.S.O. File 99-7625	Page - 19 -
-------------------------------	------------------------	------------------	--------------------------	----------------

Robert Lloyd
Thornton Police



Steve Adams
Arvada Police



Tony Gallardo
Arapahoe Sheriff Dept

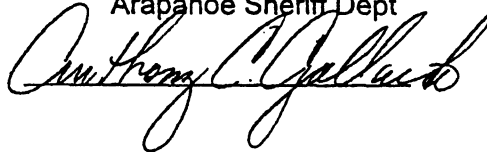

Bruce Davis
Greenwood Village Police

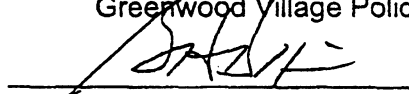

Steve Stalter
Jefferson County Sheriff

ALL TEAM MEMBERS HAVE REVIEWED THIS REPORT AND CONCUR

RHL:rl 052099 SDA:020700
JCSO case report 99-7625
TPD, case report 99-4919

JC-001-012473